

SHEET - 1

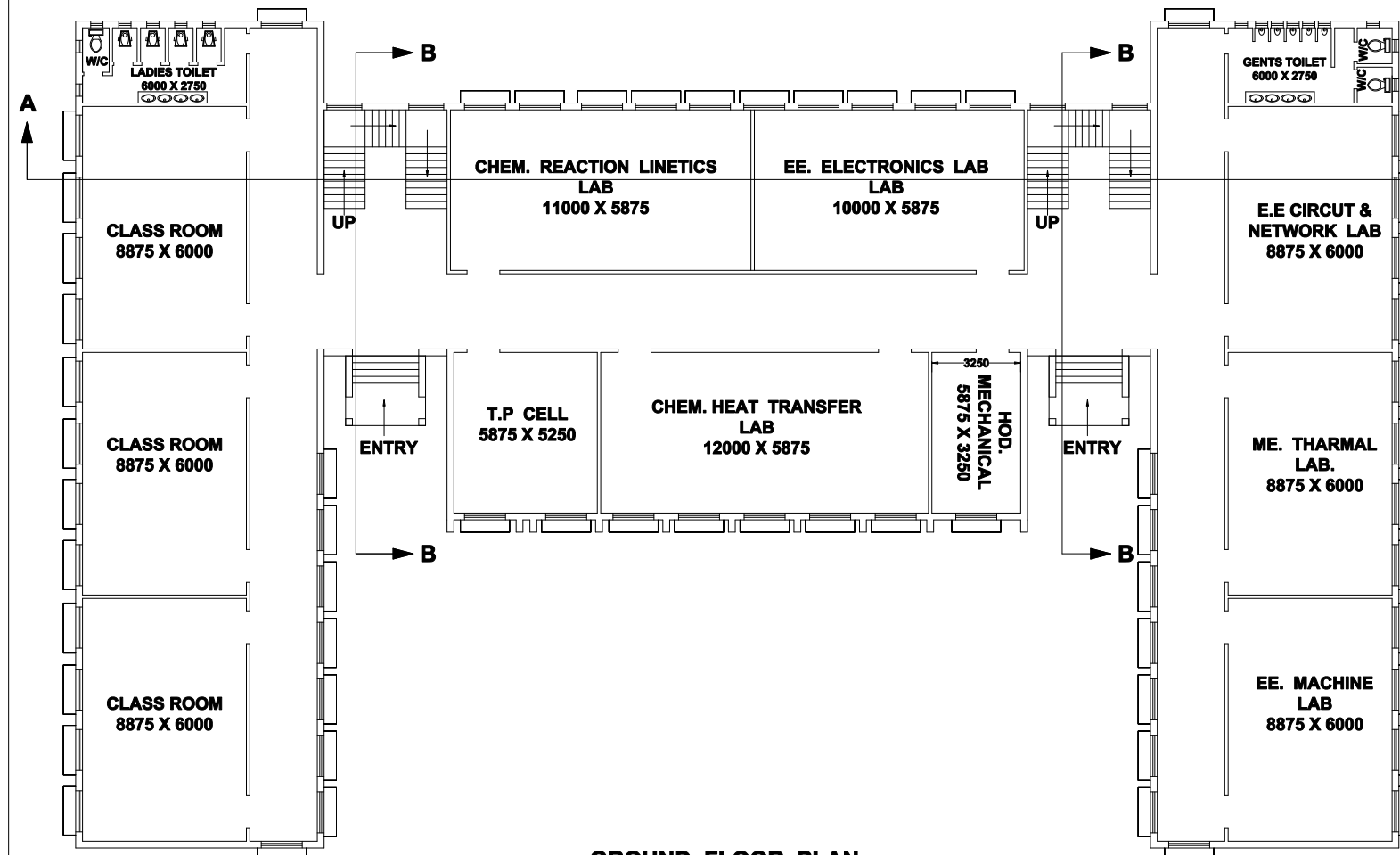

GROUND FLOOR PLAN

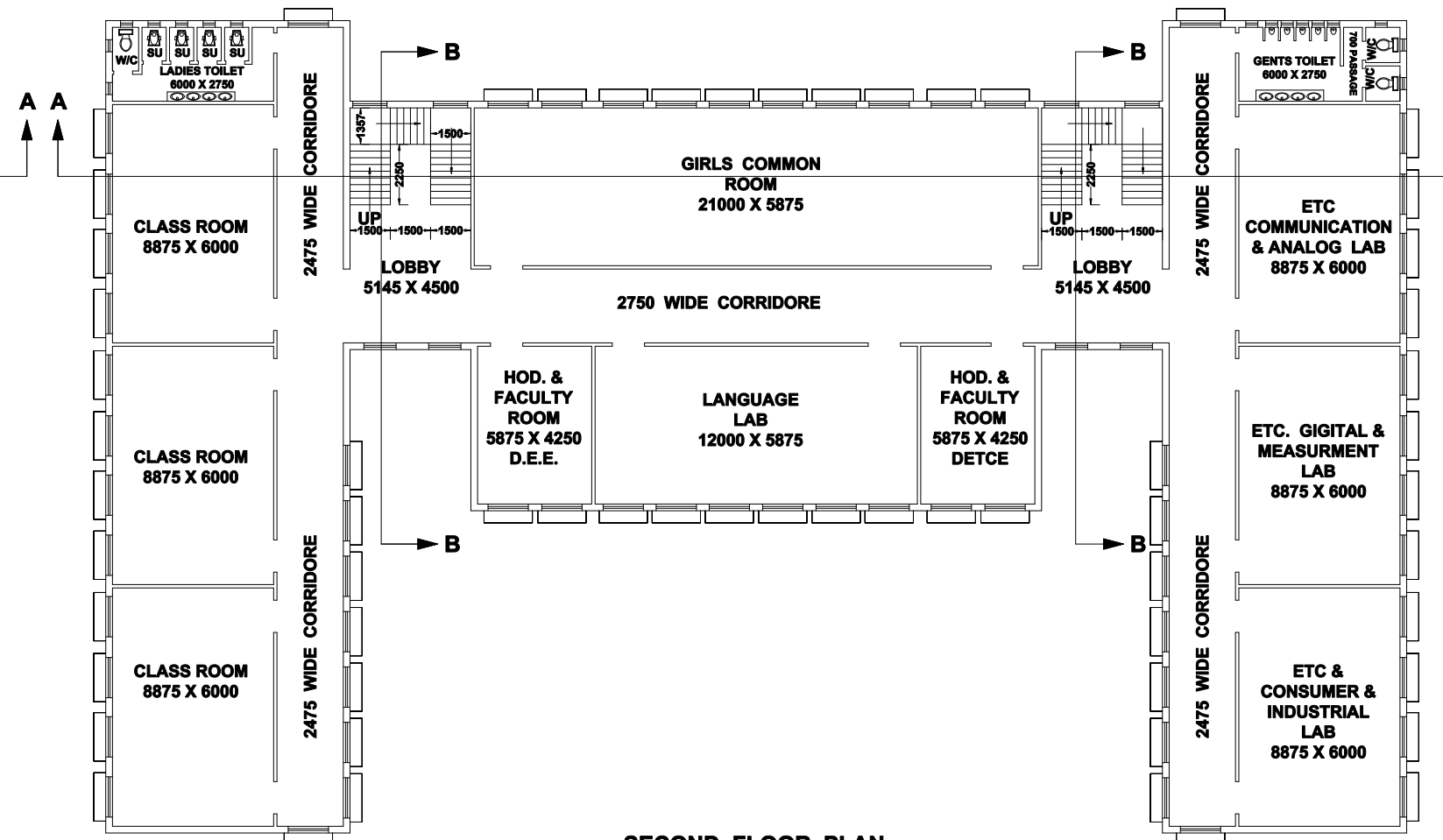

SECOND FLOOR PLAN

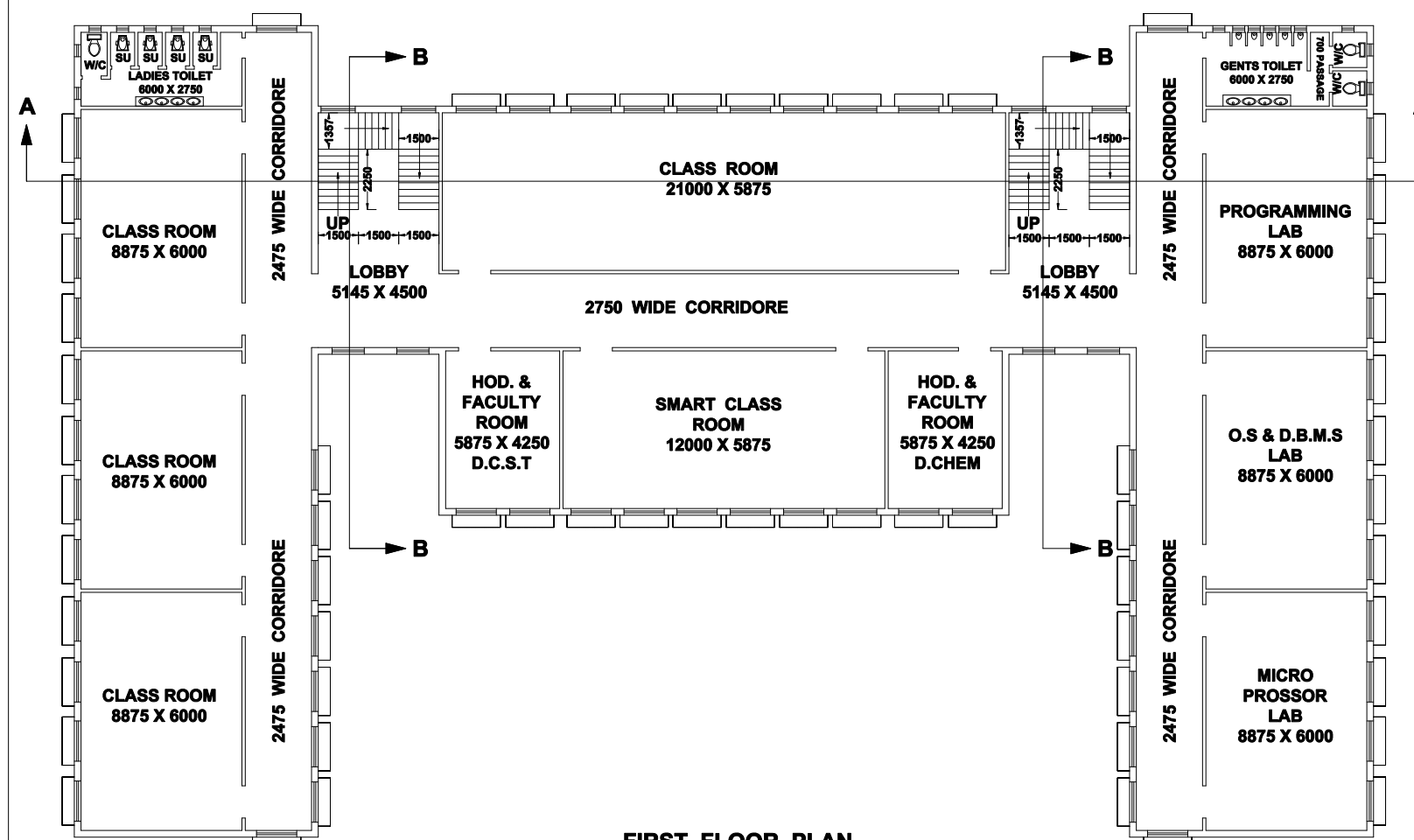

FIRST FLOOR PLAN

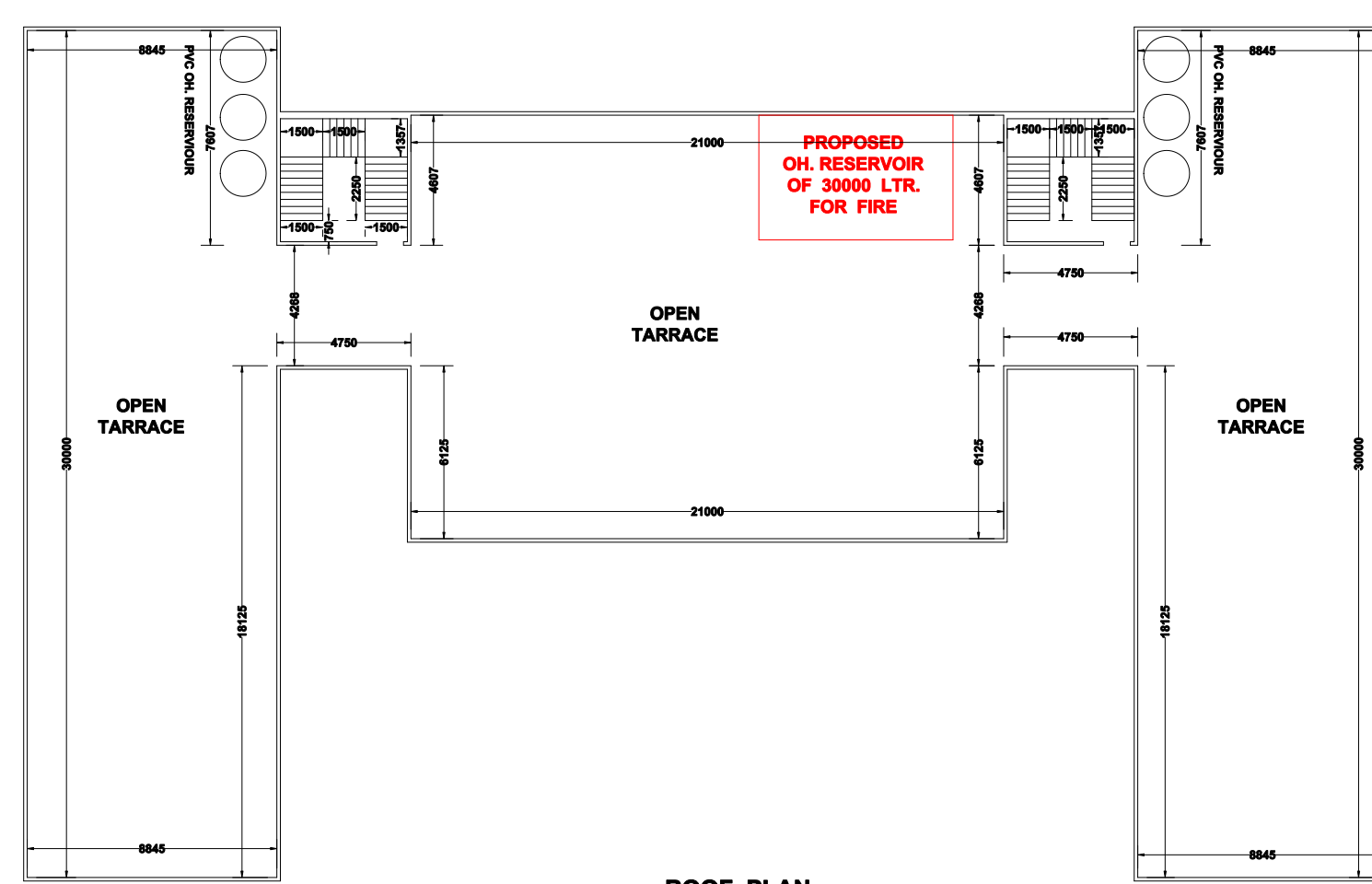

ROOF PLAN

THE SYSTEM OF FIRE FITTING WHICH WILL USED IN THE BUILDING

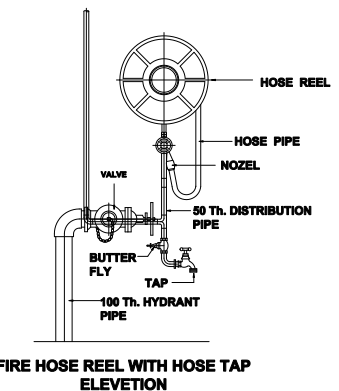
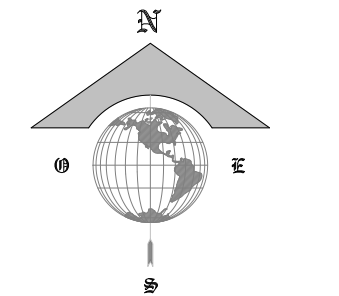

FIRE HOSE REEL WITH HOSE TAP ELEVATION

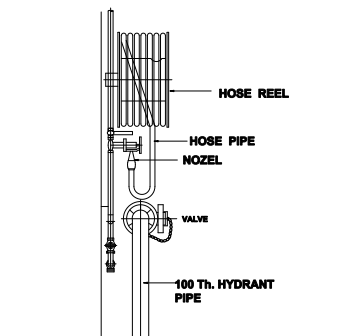

FIRE HOSE REEL WITH HOSE TAP SECTION

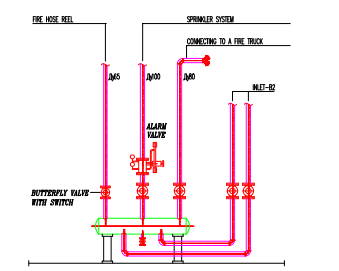

FIRE COLLECTION SYSTEM

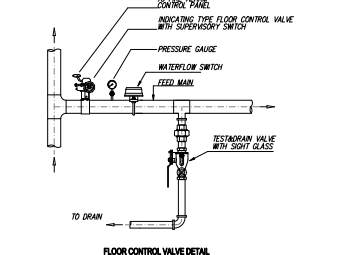

FLOOR CONTROL VALVE DETAIL

KEY PLAN FOR FIRE
 EXISTING G+2 STORIED NEW ACADEMIC BUILDING PLAN OF CONTAI POLYTECHNIC COLLAGE REGISTERED UNDER THE DEPARTMENT OF TECHNICAL EDUCATION TRAINING & SKILL DEVELOPMENT AT THE SITE ACCORDING TO ITS ACTUAL POSITION OF MOUZA - BRAHMANSHASAN , JL NO - 481, & RAGHURAMPUR, JL NO - 480, SITUATED AT PS - CONTAI, PO- DARUA , DIST - PURBA MEDINIPUR. UNDER THE JURISDICTION OF DESHAPRAN BLOCK, CONTAI & CHALTI GRAM PANCHAYET

1. PROPOSED UG. RESERVOIR IF NECESSARY : ONE PROPOSED UG. RESERVOIR OF 90,000 ltr. (FOR FIRE)
2. THERE IS NO EXTERNAL WATER SOURCE NEAR THE BUILDING
3. THERE IS A EXISTING PUMP HOUSE WITH 4 hp.SUBMERSIBLE FOR INTERNAL USE AT THE PROJECT.
4. THERE IS NO OTHER EXTERNAL PUMP FOR EMERGENCY USE AT NEW ACADEMIC BUILDING. (ONE PROPOSED PUMP ROOM PROVIDED NEAR NEW ACADEMIC BUILDING.
5. THERE IS 3NOS OF EACH SINGLE PART OF PVC O.H RESERVOIR THERE.
 - a. FOR GENERAL PURPOSE USES, CAPACITY - 3,000 Ltr. X2
 - b. NONE IS FOR FIRE & EMERGENCY USES (ONE PROPOSED OH.RESERVOIR OF 30,000 Ltr. FOR FIRE ARE PROVIDED)
6. ALL THE DIMENSION ARE IN mm. & SCALE TO BE SHOWN 1 : 100
7. ALL EXTERNAL WALLS ARE MADE WITH 250 th. & SOME WHERE FOUND 500 th. & INTERNAL WALLS ARE MADE WITH 125 th.SOME WHERE IT IS FOUND 300 th. UNLESS OTHERWISE STATED.
8. TWO NOS. OF COMMON STAIR ARE PROVIDED.
9. SPECIFICATION FOR MATERIALS & WORKMANSHIP AS PER NBC IS. 1984.
10. THE BUILDING IS AN EXISTING BUILDING.

THE INSTITUTE AUTHORITY
 DIRECTORATE OF TECHNICAL EDUCATION & TRAINING, UNDER THE DEPARTMENT OFTECHNICAL EDUCATION TRAINING & SKILL DEVELOPMENT, KARIGORI BHAVAN, 4TH. FLOOR, PLOT - B / 7, ACTION AREA - III, NEW TOWN, RAJARHAT, KOLKATA - 700160.

AREA STATEMENT OF THE LAND

AREA OF LAND = 1,22,6206.57 SFT. 113959.71 M². 2816 Dec. 1706.67 Kh.

AREA STATEMENT OF THE FLOOR

GR . COVERAGE AREA = 19716.732 SFT . 1832.41 M² (44.895 %)
 AREA OF THE GR.FLOOR COVERED AREA = 19716.732 SFT . 1892.582 M²
 AREA OF THE 1ST.FLOOR COVERED AREA = 18484.303 SFT . 1717.872 M²
 AREA OF THE 2ND.FLOOR COVERED AREA = 18484.303 SFT . 1717.872 M²
 TOTAL FLOOR AREA COUNTED EXCEPT ROOF - 5328.326 sqm.
 F.A.R = 126.935

SCALE OF PLAN
1 : 100

SITE PLAN
WILL BE
SHOWING
AT ANOTHER
SHEET NO - 5

SIGN OF PRINCIPLE /
INSTITUTE AUTHORITY

DRAWN BY :
SUBHASIS KAR (DIP. CIVIL ENGG)
L.B.S KALYANI
LICENCE NO - SEC (C)/ NO-05 - 2016

SIGN OF BOARD OF DIRECTOR

SIGN OF ENGG (L.B.S)